

Lyman 1853 Enfield Rifle Musket .58

Barrel and Sight Group

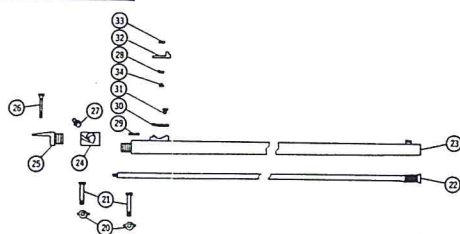

COMPONENTS

Dwg. Pc. Mk.	Part Number	Description	Dwg. Pc. Mk.	Part Number	Description
22	6020066	Ram Rod	29	6020069	Pin-Rear Sight
23	6020067	Barrel	30	6020070	Spring Rear Sight
24	6020033	Breech Plug	31	6020071	Screw-Sight Spring
25	6020034	Tang	32	6020072	Elevator-Rear Sight
26	6020035	Tang Screw	33	6020073	Slide-Rear Sight
27	6020036	Nipple	34	6020074	Screw-Slide
28	6020068	Slide Retaining Spring			

Stock and Lock Group

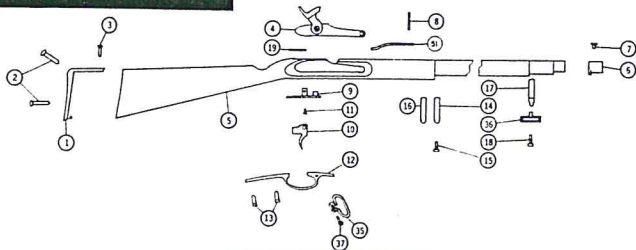

COMPONENTS

Dwg. Pc. Mk.	Part Number	Description	Dwg. Pc. Mk.	Part Number	Description
1	6020010	Butt Plate	14	6020063	Barrel Band Rear
2	6020011	Screw-Butt Plate	15	6020025	Screw-Barrel Band Rear & Middle
3	6020012	Screw-Butt Plate Upper	16	6020064	Barrel Band Middle
4	6020060	Lock Plate Assy	17	6020065	Barrel Band Front
5	6020061	Stock	18	6020027	Screw-Barrel Band Front
6	6020015	Forend Cap	19	6020028	Pin-Lock
7	6020016	Screw Forend Cap	20	6020029	Bushing-Lock Screw
8	6020017	Pin Stock	21	6020030	Screw-Lock Screw
9	6020018	Trigger Plate	35	6020075	Swivel-Trigger Guard
10	6020019	Trigger	36	6020045	Swivel Front
11	6020020	Pin-Trigger	37	6020076	Screw-Trigger Guard Swivel
12	6020021	Trigger Guard			
13	6020022	Screw-Trigger Guard			

Lyman 1853 Enfield Rifle (continued)

Percussion Lock Assembly

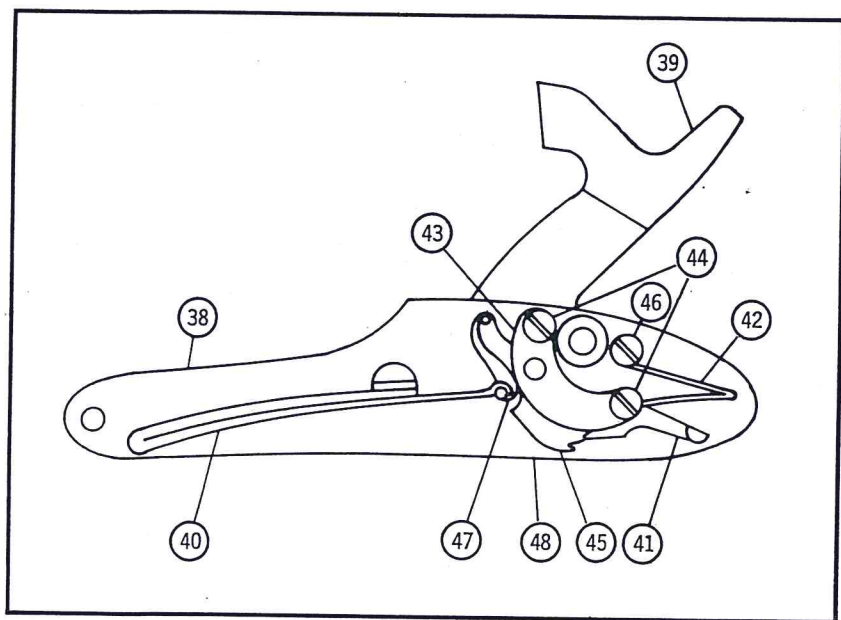

COMPONENTS

Dwg. Pc. Mk.	Part Number	Description
38	6020077	Lock Plate
39	6020047	Hammer
40	6020048	Main Spring
41	6020049	Sear
42	6020050	Sear Spring
43	6020051	Bridle
44	6020052	Bridle Screw
45	6020053	Tumbler
46	6020054	Screw-Sear Spring
47	6020055	Pivot Link
48	6020056	Hammer Screw

Suggested loads for Lyman black powder guns

The following loads are good combinations of propellant and projectile—not maximum or minimum loads. For much greater coverage, see Lyman's BLACK POWDER HANDBOOK.

REVOLVERS

- .36 - .380" ball/26 grs. G-O 3Fg/1050 fps/#11 caps
- .44 - .454" ball/34 grs. G-O 3Fg/1000 fps/#11 caps
- .45468/30 grs. G-O 3Fg/800 fps/#11 caps

SINGLE SHOT PISTOL

- .45 - .440 ball with .012" patch/20 grs. G-O 3Fg/700 fps/#11 caps

PLAINS RIFLES (28" bbls.)

- .45 - .445" ball/.012" patch/50 grs. G-O 3FG/1438 fps/#11 caps
- #454616/45 grs. G-O 3Fg/1236 fps/#11 caps
- #454613/50 grs. G-O 3Fg/1212 fps/#11 caps
- #454612/50 grs. G-O 3Fg/1232 fps/#11 caps
- .50 - .490" ball/.012" patch/70 grs. G-O 3Fg/1587 fps/#11 caps
- #504617/65 grs. G-O 3Fg/1262 fps/#11 caps
- .54 - .535" ball/.012" patch/70 grs. G-O 3Fg/1375 fps/#11 caps
- #540620/60 grs. G-O 3Fg/#11 caps
- #542622/60 grs. G-O 3Fg/#11 caps
- .58 - .560" ball/.012" patch/70 grs. G-O 2Fg/998 fps/#11 caps
- Muskets: #580213/70 grs. G-O 2Fg/750 fps/#11 caps
- Zouave (32" bbl.) - .560" ball/.012" patch/70 grs. G-O 2Fg/
1115 fps/Musket caps
- #580213/60 grs. G-O 2Fg/800 fps/Musket caps
- Musketoon (24" bbl.) - .560" ball/.012" patch/70 grs. G-O 2Fg/
1077 fps/Musket caps
- #577611/70 grs. G-O 2Fg/892 fps/Musket caps
- #580213/70 grs. G-O 2Fg/898 fps/Musket caps
- X Enfield 3-Band (39" bbl.) - .560" ball/.012" patch/70 grs.
G-O 2Fg/1120 fps/Musket caps
- #57764/70 grs. G-O 2Fg/830 fps/Musket caps
- #580213/70 grs. G-O 2Fg/840 fps/Musket caps

*Pyrodex may be safely substituted on a volume equivalency basis.